

48" Cart-Mate Cabinet

48048L CABINET

- All laminate base cabinet with 2 doors, 1 adjustable shelf and cart-port
- Easy-clean, all laminate surfaces
- Tough, chip resistant edges
- Unit is pre-assembled to save installation time
- Fully adjustable, soft-close hinges
- 3.25" backsplash included with top
- Satin finish pulls
- Choice of solid color or woodgrain laminate finishes for cabinet
- Choice of 6 laminate countertop finishes
- Optional sink positioned as shown
- Door locks available

CART

- All laminate cabinet mounted on four, locking, 3" swivel casters
- 4 soft-close drawers that hold up to 75 lbs. each
- ClintonClean™ solid plastic bumper
- One-piece, vacuum-formed, gray-haircell, textured, top rimmed on all sides
- Satin finish pulls
- Choice of solid color or woodgrain laminates
- Drawer locks available

CART-MATE™
CABINETS



Shown with -022 optional sink



CLASSIC CLINTON
• LAMINATE CASEWORK •



California residents please be advised of the following, pursuant to Proposition 65:

1
WARNING: This product can expose you to chemicals, including chromium, which is known to the State of California to cause cancer or reproductive toxicity. For more information go to www.P65Warnings.ca.gov.

OVERALL CABINET SPECIFICATIONS

48" W x 18" D x 35" H

OVERALL CART SPECIFICATIONS

20" W x 18.5" D x 29.5" H

OPTIONS



022 Stainless Steel sink and chrome faucet set

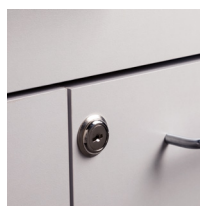

055 Door & Drawer Locks

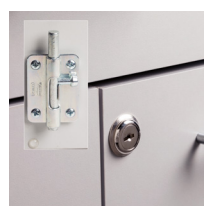

066 Door Locks & Inside Latch

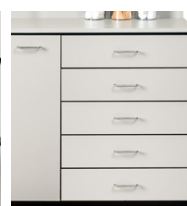

044 Add a Drawer cannot be used with a sink option



42 Cart Option

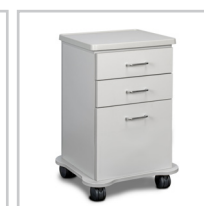

43 Cart Option

Cabinet and Countertop colors

CLASSIC CLINTON •LAMINATE CASEWORK•

Laminate Cabinet Colors

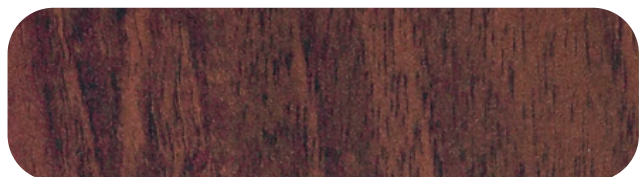

Dark Cherry



Maple



Slate Gray



Gray

Laminate Countertop Colors

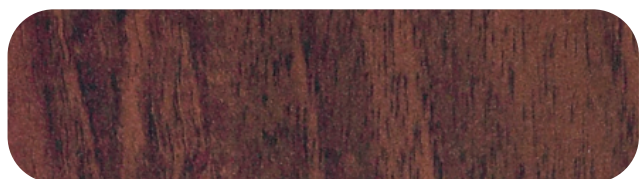

Dark Cherry



Maple



Slate Gray



Gray



Classic Marble

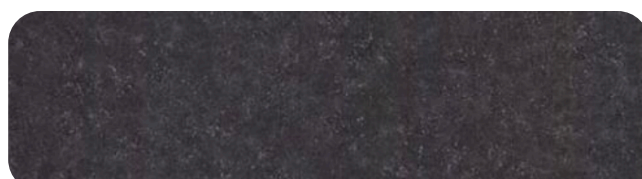

Graphite Talc

NOTE: *Classic Marble laminate mirrors the beauty of actual marble, so as with actual marble, the veining can vary in width and color intensity.*