



SPEC SHEET

KoolMore 24 in. Built-in Two-Drawer Refrigerator in Stainless-Steel For Outdoor Kitchen

Model: KM-OKS-RD2

FEATURES

- **Durable Design:** Stainless-steel black and silver exterior for a sleek, weather-resistant look.
- Dual Drawers:** Two independent drawers for organized storage of beverages, snacks, or produce.
- Weather-Resistant:** IPX4 rating for reliable outdoor performance.
- Temperature Control:** Adjustable 32–50°F for versatile cooling needs.
- Quiet Operation:** Operates at just 46 dB for minimal noise.
- Built-In Ready:** Seamlessly fits into outdoor kitchens with no clearance needed.
- Soft Close Drawers:** Smooth operation enhances usability and durability.
- Extra Features:** Adjustable feet, automatic cooling, and front plinth exhaust for easy setup.
- Cutout Dimensions:** Fits 24" x 22.9" x 34.3" spaces for built-in installations.
- Energy Efficient:** DOE compliant, using just 256 kWh/year.
- Certified & Backed:** ETL certified with a 1-year warranty.
- Outdoor Suite Compatible:** Integrates with KoolMore Outdoor Kitchen Suite.



CLOSE UP IMAGES



TECHNICAL SPECS

Dimensions

Length	23.4
Width	22.5
Height	33.9
Interior Depth	17.3
Interior Width	20.2
Interior Height	25.7
Ambient Temperature Range	50-110 F
Defrost Type	Manual
Depth Including Handles	24
Depth Excluding Handles	22.63
Depth Less Door	21.06
Depth With Drawer Open	Drawer fully extended: 34.3
Power Cord Length	59

Capacity

Cubic Feet	4.9
------------	-----

Features & Material

Door Style	Drawer
Number of Drawers	2
Plug Type	NEMA 5-15P
Refrigerant Type	R-600a
Temperature Range	32-50 F

Electric & Certification

Voltage	115
Phase	1
Exterior Material	Stainless-Steel
Hertz	60
Wattage	80
Amps	1.3
Certifications	ETL Listed for Safety

Plan View

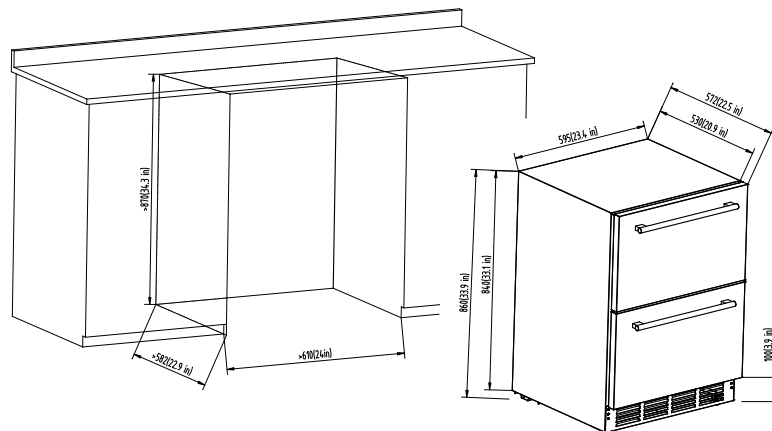
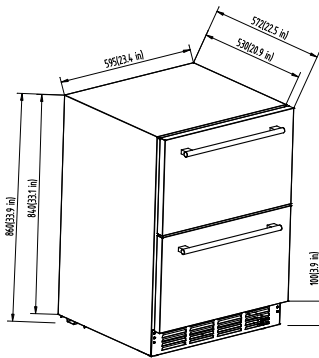

CERTIFICATIONS



706 Eastern Parkway STE 1G, Brooklyn NY 11213
718-576-6342
info@koolmore.com